

Applications

Lifting of steel drums with rim - full or empty, open or closed – in vertical or horizontal position.

Description

Accessory composed of a two-leg sling fitted with two clamps which are equipped with a system of drum rim pinch.
 Clamping is proportional to the load, thus minimising the damage risk.

Functioning

Position the two clamps facing each other on the drum taking care that the jaws are in contact under the rim. A spring ensures the positioning of the clamps ready to use on the drum. The lifting can be performed. When the load lays down, the operator can manually disengage the clamps.

Particular instructions

- Only lift standard steel drums with rim with VDL clamps.
- Always use the two clamps.
- Never overturn drums with these clamps.
- VDL is not suitable for plastic drums.
- Working temperature: -20° to +100°C.

General characteristics

- Manufacture without load bearing welds.
- Hot epoxy coating.
- Safety factor: 3 in accordance with the EN 13155.2003 norm.

Dimensional characteristics

Ref.	Group code	WLL kg	Chain Ø	drum Ø or length (min/ max)	A	B	C	D	Weight kg
VDL-1	54398	1000	6	150/ 950	516	93	66	13	3,5

Dimensions in mm

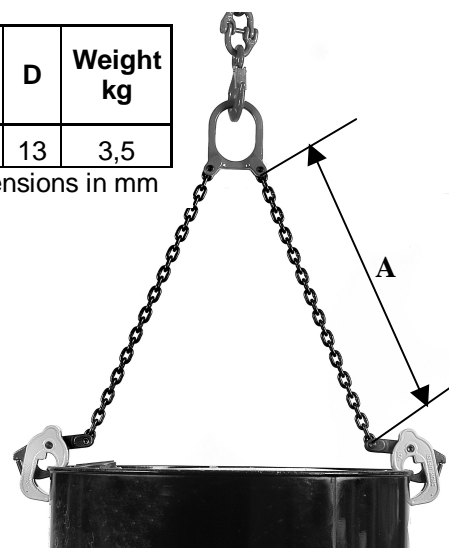
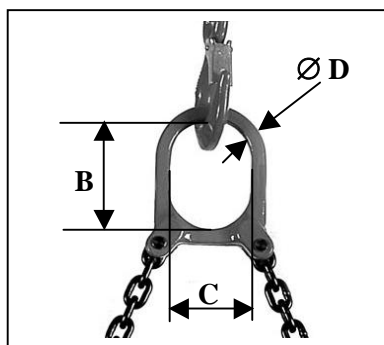

Subjected to technical modification without notice - Non contractual document.

General characteristics

- Manufactured without load bearing welds.
- Hot epoxy coating.
- Safety factor: 3 in accordance with the EN 13155.2003 nom.
- Product conforms to the French regulation, in particular the decree of 01/03/2004 relating to the check on lifting devices and the European Directive n°98/37.
- Product with EC marking and delivered with a declaration of conformity and instructions for use.

Dimensional characteristics

Ref.	Group code	WLL kg	Drum Ø	A	B	C	D	E	F	G	H	I	J	K	L	Weight kg
VLFO5 600	51268	500	600	323	114	417	51	121	52	18	69	80	16	70	90	6,6
VLFO8 600	51278	800	600	345	132	420	46	128	52	18	69	91	16	70	90	8,9

Dimensions in mm

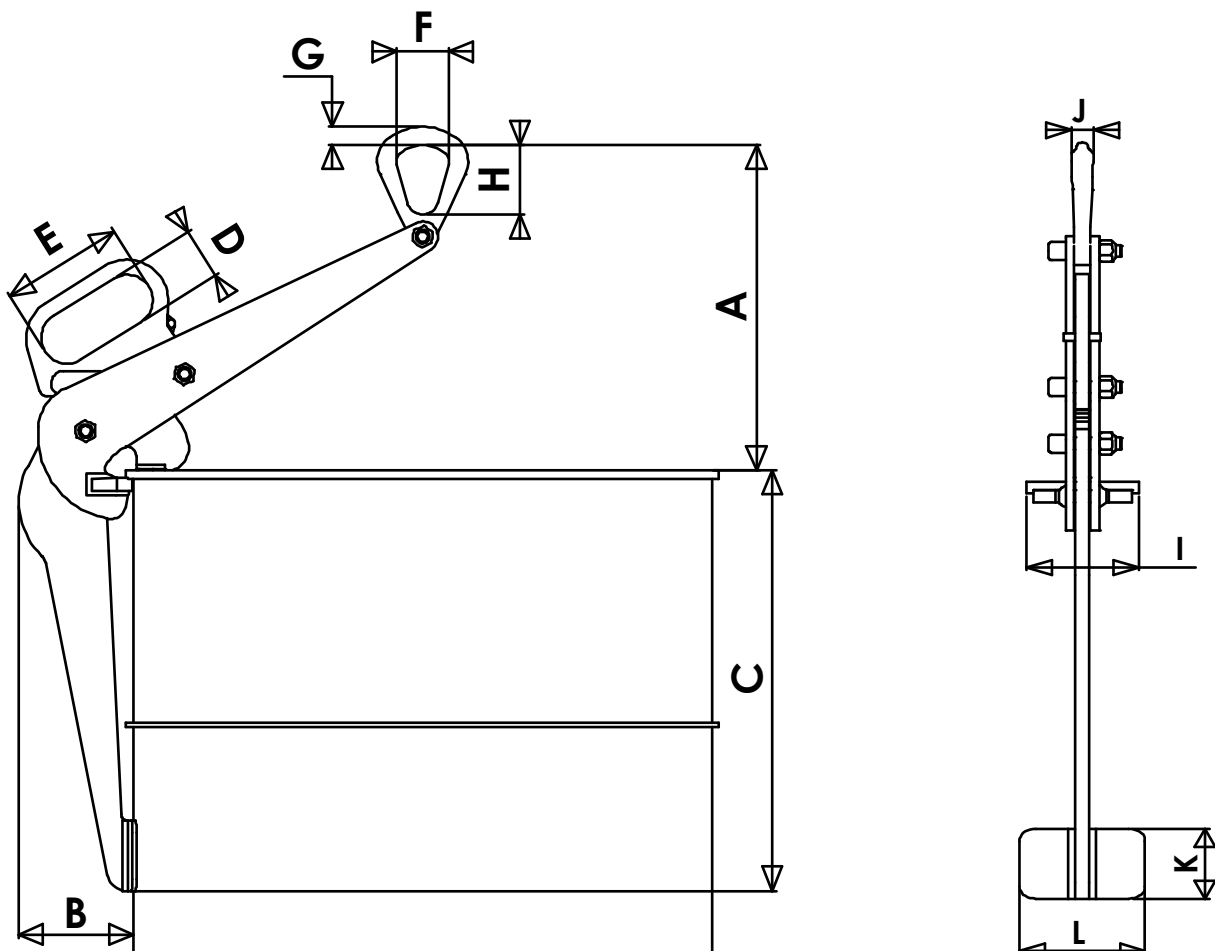

Applications

Lifting of closed steel drums – full with a lid or empty – in vertical position and with diameter 400 to 600 mm.

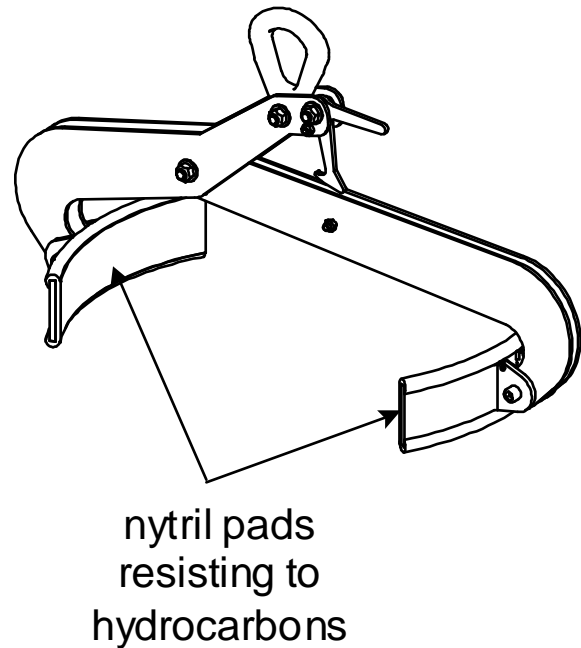
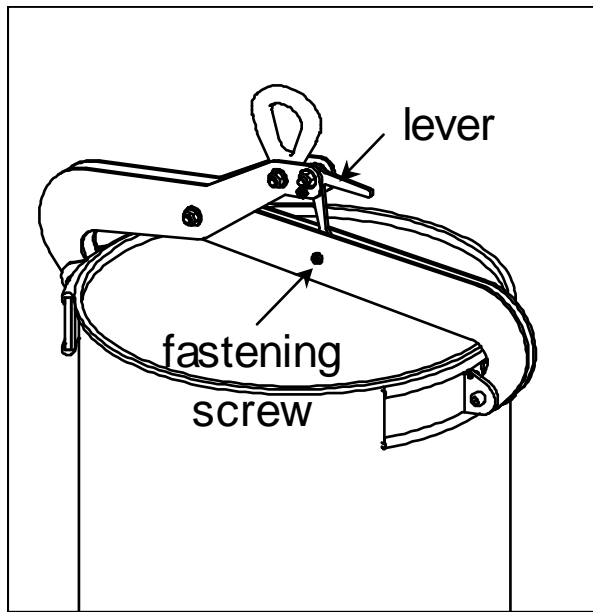

Description

Accessory equipped with an open position locking system allowing to lay down the drum without any manual intervention. Nytril coated pads ensure a great adherence and avoid marring the drums. Clamping is proportional to the load, thus minimising the drum's damage risk.

Functioning

Place the clamp locked in the open position over the drum. Lift up the lever, while starting off the lift and hold it up to prevent it from locking again against the fastening screw. When laying down, the clamp automatically locks itself in the open position.

Important instructions

- Ensure the pads are free from grease or oil.
- Never lift greasy or oily drums.
- Not suitable for plastic drums.
- Never lift drums with sizes exceeding the opening capacity of the damp used.
- Drum deformation risk in case of open drum lifting (without lid).
- The minimum weight of lifting load should be equal to 5% of the damp's WLL (eg if damps WLL is 1000 kg, then minimum weight is 50 kg). This value is given for a damp in perfect working order and respecting Tractel Solutions SAS conditions of use and recommendations. Consult Tractel in case of loads with weight inferior to the minimum recommended value.
- Lifting clamps are not suitable for creating permanent joints.
- Working temperature: -20° to +90°C.

General characteristics

- Manufactured without load bearing welds.
- Hot epoxy coating.
- Safety factor: 3 in accordance with the EN 13155.2003 nom.
- Product conforms to the French regulation, in particular the decree of 01/03/2004 relating to the check on lifting devices and the European Directive n°98/37.
- Product with EC marking and delivered with a declaration of conformity and instructions for use.

Dimensional characteristics

Ref.	Group code	WLL kg	Drum Ø	A		B		C		D		E	F	G	H	I	J	K	Weight kg
				min	max	min	max	min	max	min	max								
VFR05-5	51248	500	400-500	297	405	673	725	110	120	115	152	80	64	23	20	62	96	270	12
VFR05-6	51258	500	500-600	327	443	767	824	110	120	115	147	80	64	23	20	62	96	320	14

Dimensions in mm

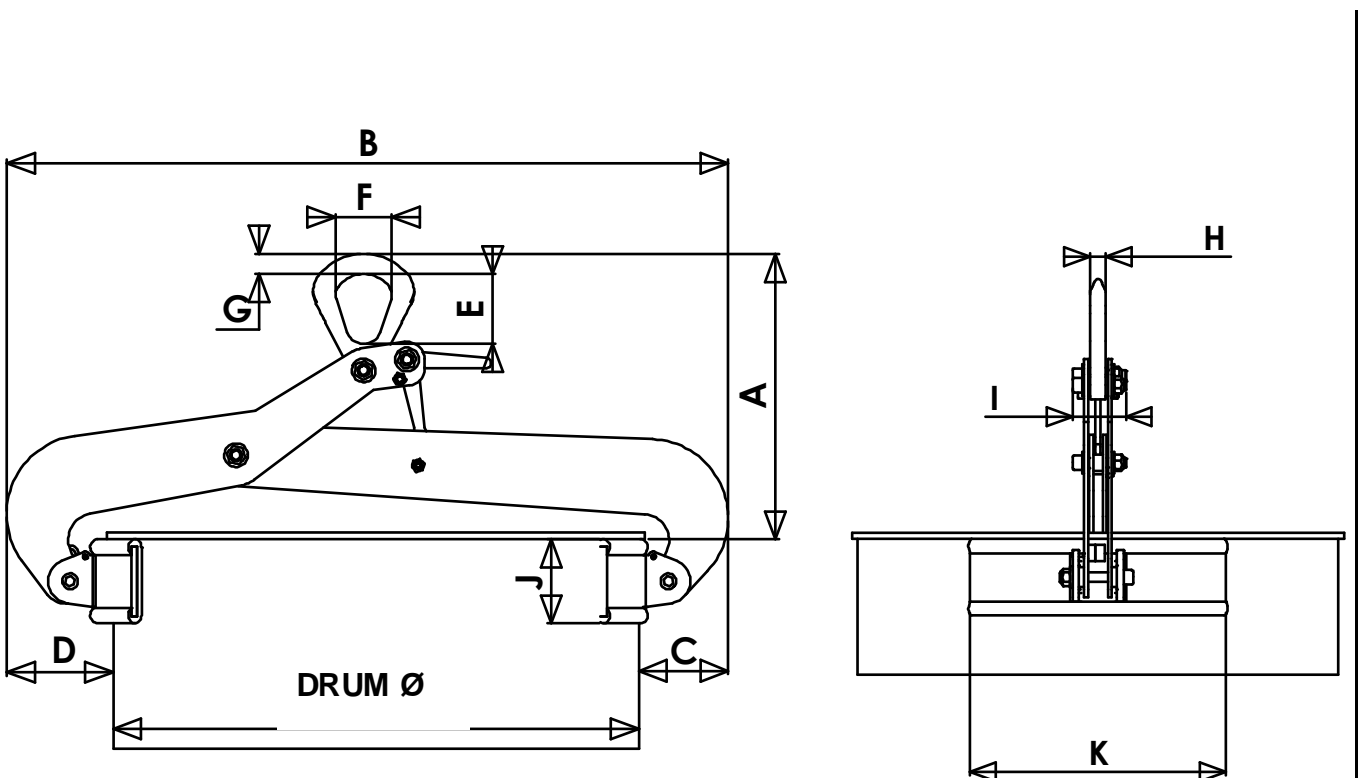

Applications

Lifting of steel drums – full with a lid or empty - in vertical position and with diameter 600 mm.

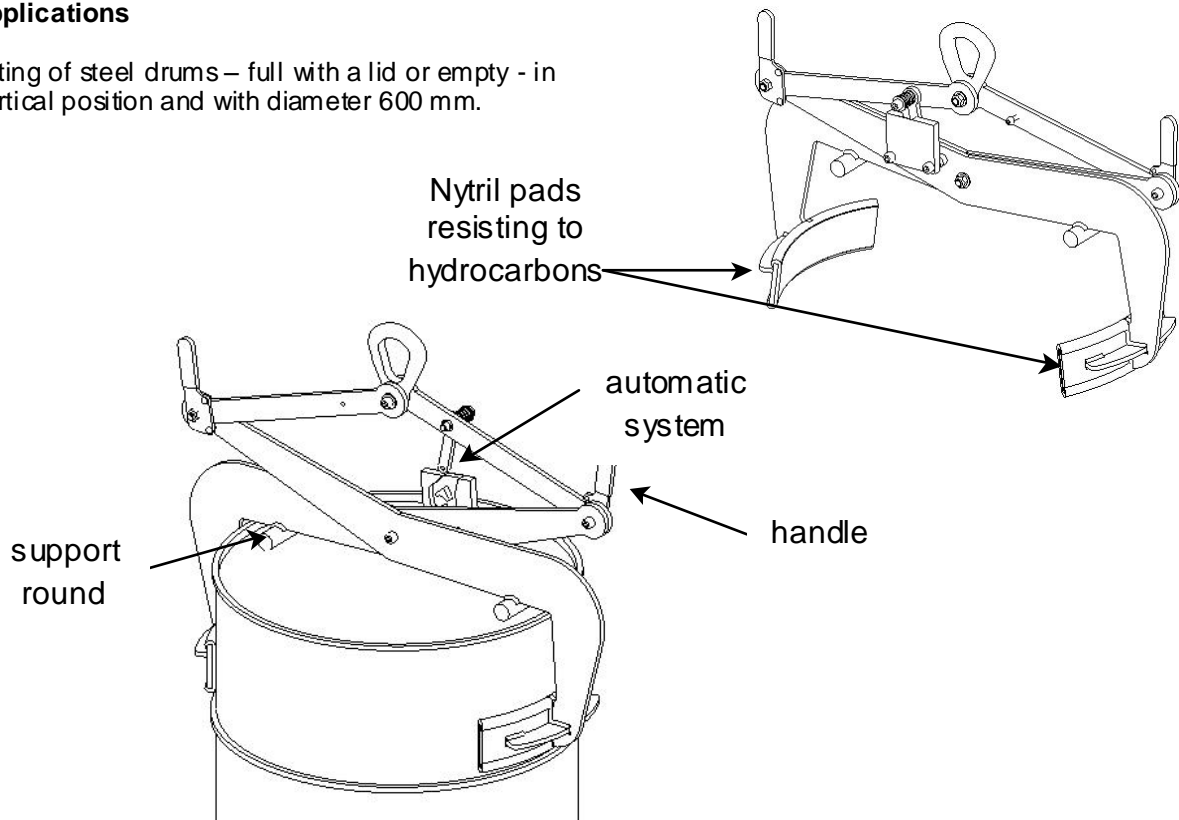

Description

Accessory equipped with an automatic system allowing to grip and lay down the drum without any manual intervention. Nytril coated pads ensure a great adherence and avoid marking the drums. Transport handles make the positioning easier. Support rounds ensure the damp's stability when it is laid down on the drum. Clamping is proportional to the load, thus minimising drum's deformation risk.

Functioning

Place the open damp over the drum and activate the lifting means. The damp grips automatically the load. When laying down, the operator must lower completely the damp onto the drum so as to activate the automatic locking system. The damp is then locked open.

Important instructions

- Make sure the pads are free from grease or oil.
- Do not lift greasy or oily drums.
- Not suitable for plastic drums.
- Do not lift drums with sizes exceeding the opening capacity of the clamp used.
- Drum deformation risk when lifting open drums (without lid).
- The minimum weight of lifting load should be equal to 5% of the damp's WLL (eg if damp's WLL is 1000 kg, then minimum weight is 50 kg). This value is given for a damp in perfect working order and respecting Tractel Solutions SAS conditions of use and recommendations. Consult Tractel in case of loads with weight inferior to the minimum recommended value.
- Lifting clamps are not suitable for creating permanent joints.
- Working temperature: -20° to +90°C.

technical sheet



VFA

automatic clamp for lifting vertical steel drum

ref. : T 6025 GB
 rev. : 8
 date : Sept 08
 page : 2 / 2

General characteristics

- Manufactured without load bearing welds.
- Hot epoxy coating.
- Safety factor: 3 in accordance with the EN 13155.2003 norm.
- Product conforms to the French regulation, in particular the decree of 01/03/2004 relating to the check on lifting devices and the European Directive n°98/37.
- Product with EC marking and delivered with a declaration of conformity and instructions for use.

Dimensional characteristics

Ref.	Group code	WLL kg	Drum Ø	A		B		C		D		E	F	G	H	I	J	Jaws length L	Weight kg
				min	max	min	max	min	max**	min	max								
VFA 025	51208	300	600	530	672	840	850	903	910	237	243	20	117	80	64	23	96	310	27

* drum grip

** max. opening of the damp

Dimensions in mm

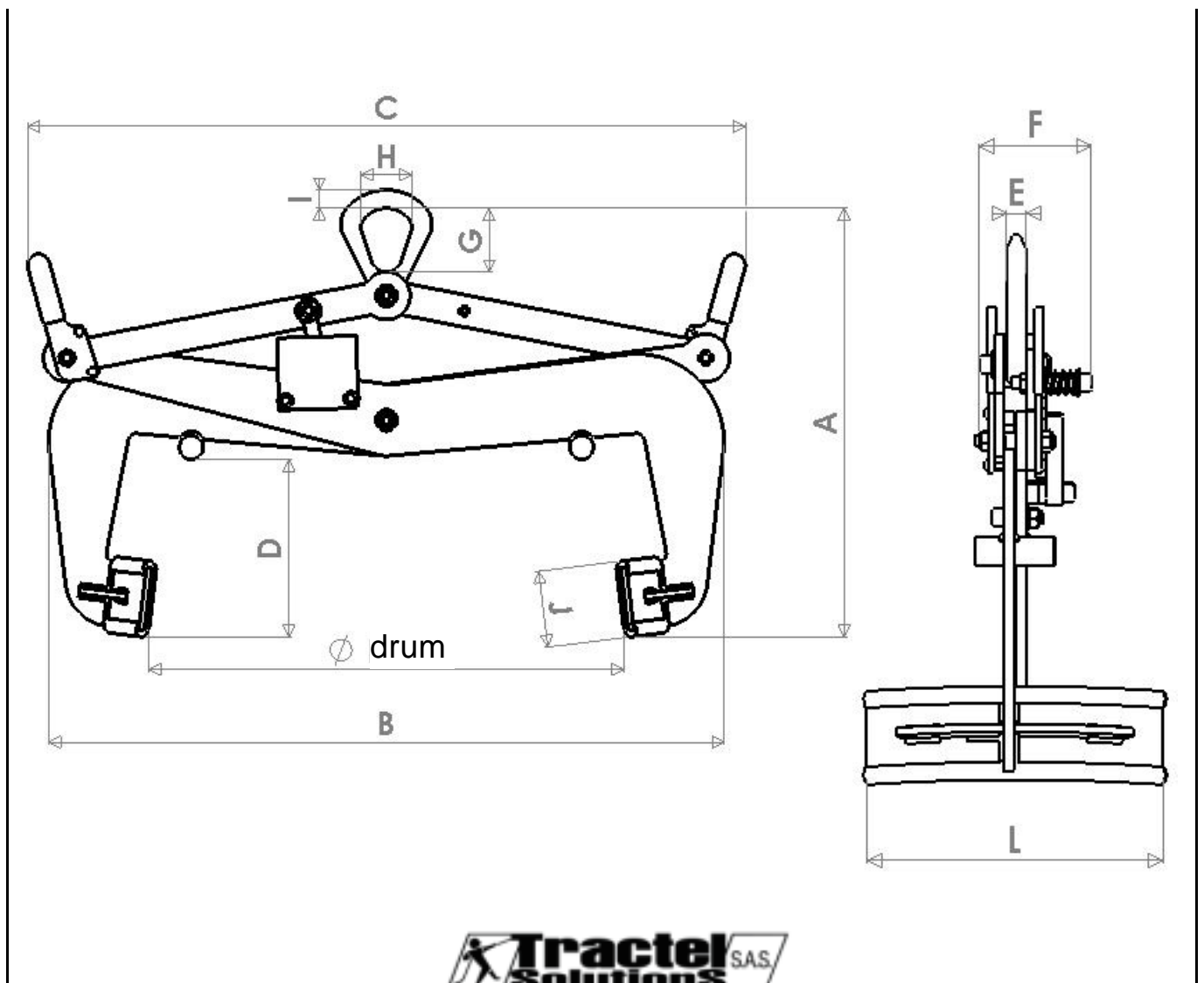

Applications

Lifting and turning steel drums – full with a lid or empty - diameter 600 mm (capacity 225 l).
 The drum may be damped vertically or horizontally.

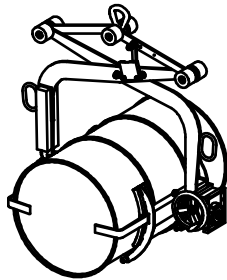
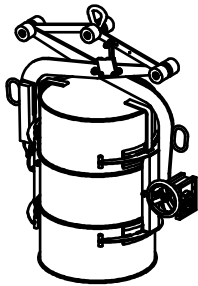

nytril pads
resisting to
hydrocarbons

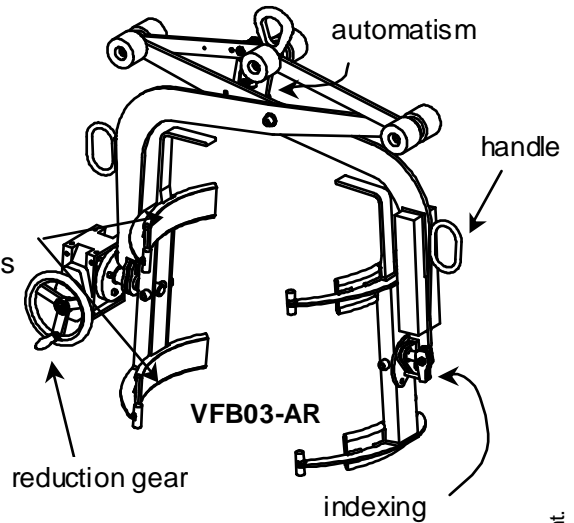

Description

VFB03-S: this model is equipped with an open position automatic locking so as to lay down the drum without any intervention on the clamp.

VFB03-A: this model is equipped with an automatic system allowing the drum's gripping and laying down without any intervention on the damp.

VFB03-AR: on top of the automatism, this model is fitted with a reduction gear so as to turn and empty the drum progressively and effortlessly.

All VFB have an indexing allowing to maintain the drum horizontally or vertically. Nytril coated pads ensure a great adherence and avoid drums' marking. Handles make the positioning easier.

Clamping is proportional to the load, thus minimising the drum deformation risk.

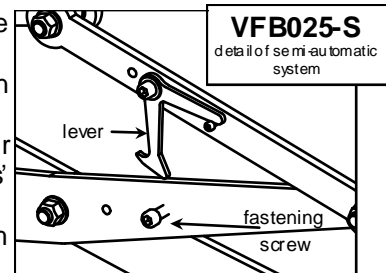

Functioning

VFB03-S: place the open damp over the drum. So as to perform lifting, the operator should activate the lever, holding it in the up position, while starting off the lift. Manual drum turning after unlocking of both indexing fingers. When laying down the load, the damp automatically locks itself open.

VFB03-A: place the open damp over the drum and activate the lifting means. The damp automatically grips the load. Manual drum turn after unlocking of both indexing fingers. When laying down the load, the operator must lower the damp completely down on the drum so as to activate the locking system automatism. The damp is then locked open.

VFB03-AR*: VFB03-A model equipped with a reduction gear so as to empty the drum gradually and effortlessly (demultiplication factor about 1/64th).

* this model is fitted with a single indexing finger.

General characteristics

- Manufactured without load bearing welds.
- Hot epoxy coating.
- Safety factor: 3 in accordance with the EN 13155.2003 nom.
- Product conforms to the French regulation, in particular the decree of 01/03/2004 relating to the check on lifting devices and the European Directive n°98/37.
- Product with EC marking and delivered with a declaration of conformity and instructions for use.

Subjected to technical modification without notice - Non contractual document.



Important instructions

- Make sure the pads are free from grease or oil.
- Degrease the pads regularly.
- Do not lift greasy or oily drums.
- Not suitable for plastic drums.
- Do not lift drums with sizes exceeding the opening capacity of the clamp used.
- Make sure jaw reinforcements are above the drum in horizontal position, otherwise the damp cannot be removed once the drum has been laid down.
- When handling and transporting the drum, make sure the indexing finger(s) are well locked so as to prevent the load untimely turning.
- The minimum weight of lifting load should be equal to 5% of the damp's WLL (eg if damp's WLL is 1000 kg, then minimum weight is 50 kg). This value is given for a damp in perfect working order and respecting Tractel Solutions SAS conditions of use and recommendations. Consult Tractel in case of loads with weight inferior to the minimum recommended value.
- Lifting clamps are not suitable for creating permanent joints.
- Working temperature: -20° to +90°C.

Dimensional characteristics

Ref.	Group code	WLL kg	Drum Ø	A	B*	C	D	E	F	G	H	I	J	Weight kg
VFB 03 S	51218	300	600	465	946	730	930	20	86	425	80	64	23	53
VFB 03 A	51228	300	600	465	946	730	930	20	170	425	80	64	23	58
VFB 03 AR	51238	300	600	465	1175	730	930	20	170	425	80	64	23	80

* When closed

Dimensions in mm

