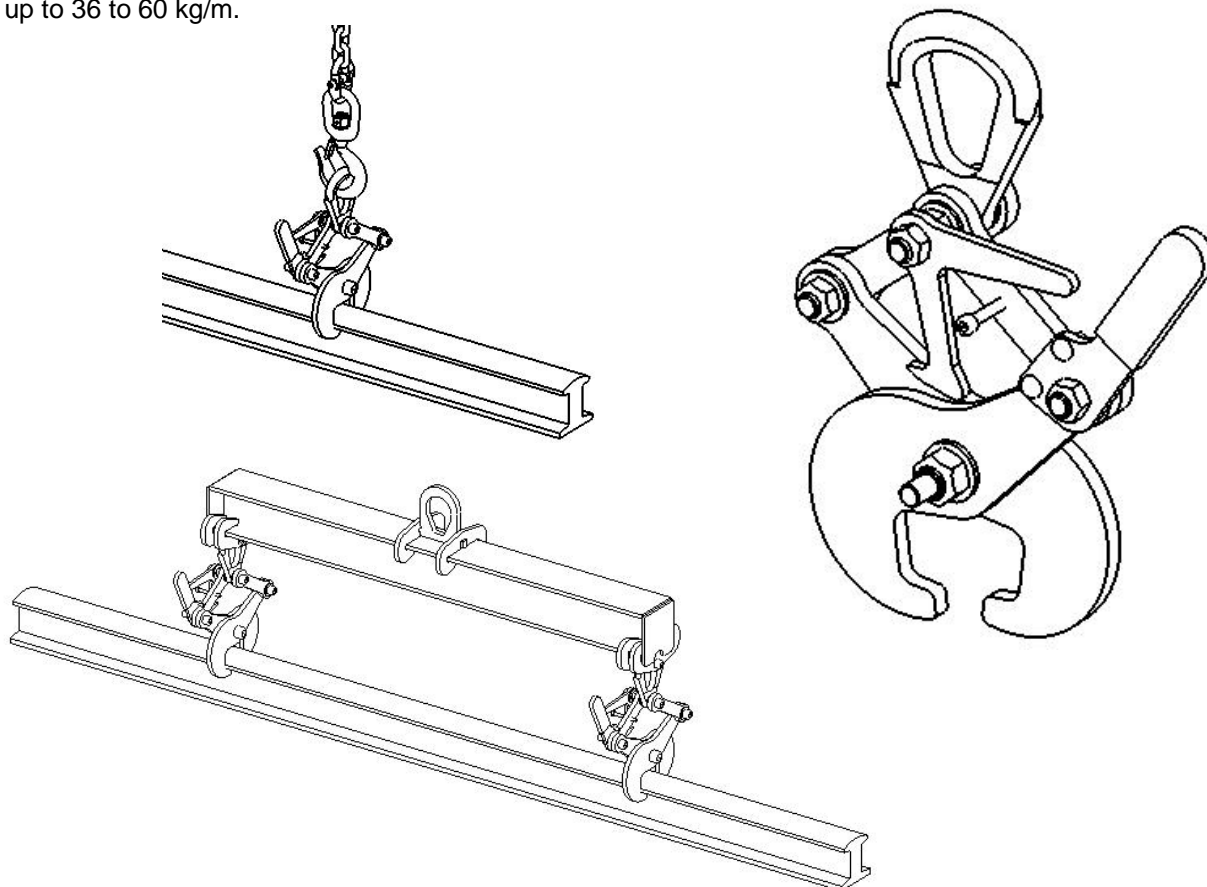

Applications

Lifting of Vignole type rails from 15 to 30 kg/m and up to 36 to 60 kg/m.

**Description**

These accessories are fitted with an open position locking system allowing to lay down the load without any manual intervention.

Functioning

Place the clamp locked open over the rail. Lift up the lever while starting off the lift and hold it in the up position to prevent it from locking again against the fastening screw. When laying down, the clamp automatically locks itself open.

Important instructions

- Only lift one load at a time.
- Vertical traction only.
- Use in pairs with lifting beam recommended.
- Working temperature: -20° to +100°C.

General characteristics

- Manufactured without load bearing welds.
- Hot epoxy coating.
- Safety factor: 3 in accordance with the EN 13155.2003 norm.
- Product conforms to the French regulation, in particular the decree of 01/03/2004 relating to the check on lifting devices and the European Directive n°98/37.
- Product with EC marking and delivered with a declaration of conformity and instructions for use.

Dimensional characteristics

Ref.	Group code	WLL t	Opening		A		B' (handle)		B		D		E	F		G	H	I	J	K	L	Weight kg
			min	max	min	max	min*	max**	min*	max**	min	max		min	max							
PR1-20-40	50618	1	20	40	292	318	142	168	95	124	174	190	40	65	80	69	52	18	16	95	22	3
PR2-40-80	50628	2	40	80	385	432	175	175	103	142	247	315	50	106	135	80	64	23	20	132	32	8

* spread clamp

** clamp with max. opening

Dimensions in mm

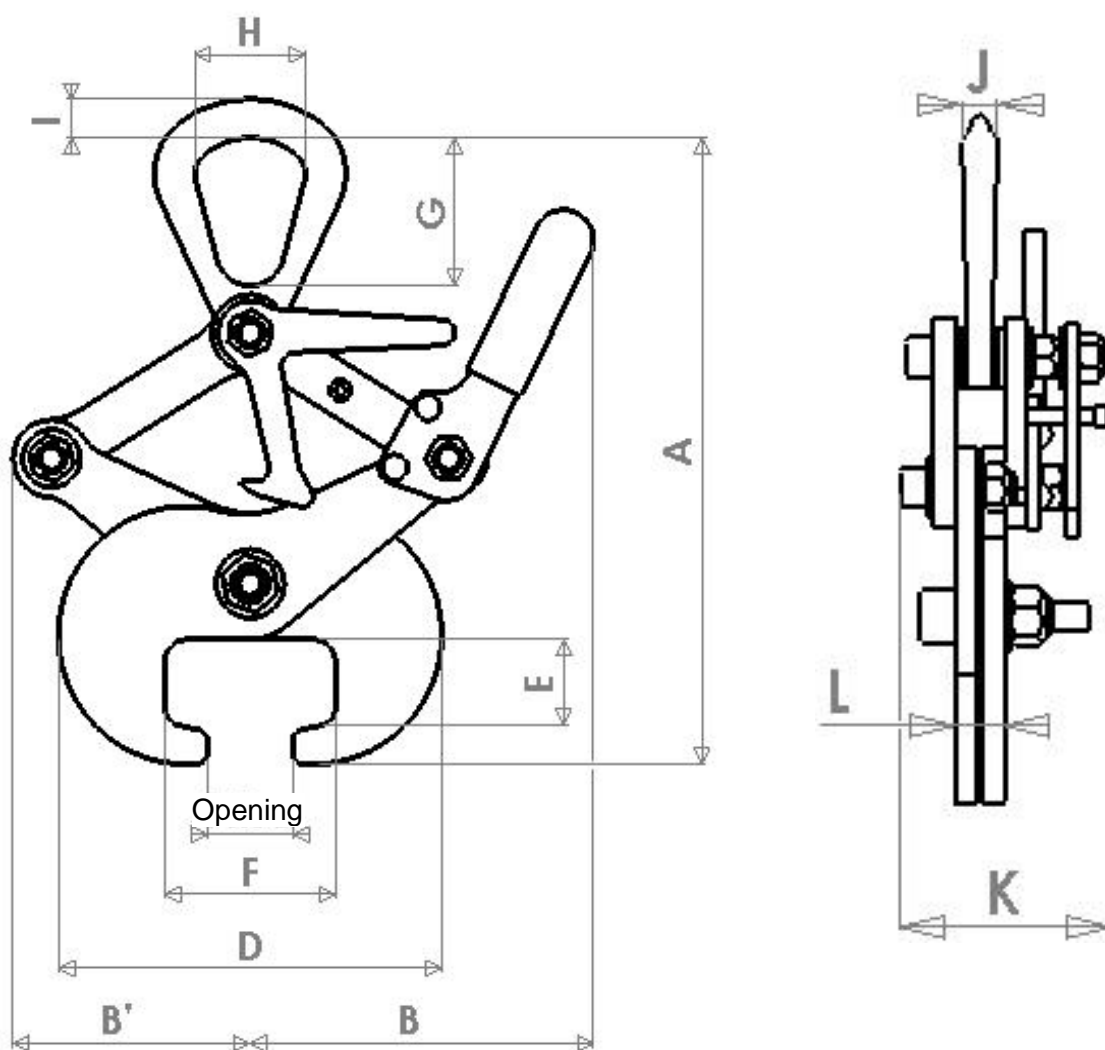

Applications

Lifting by the flange of I or H profiles ; fabricated assemblies, plates in horizontal position.

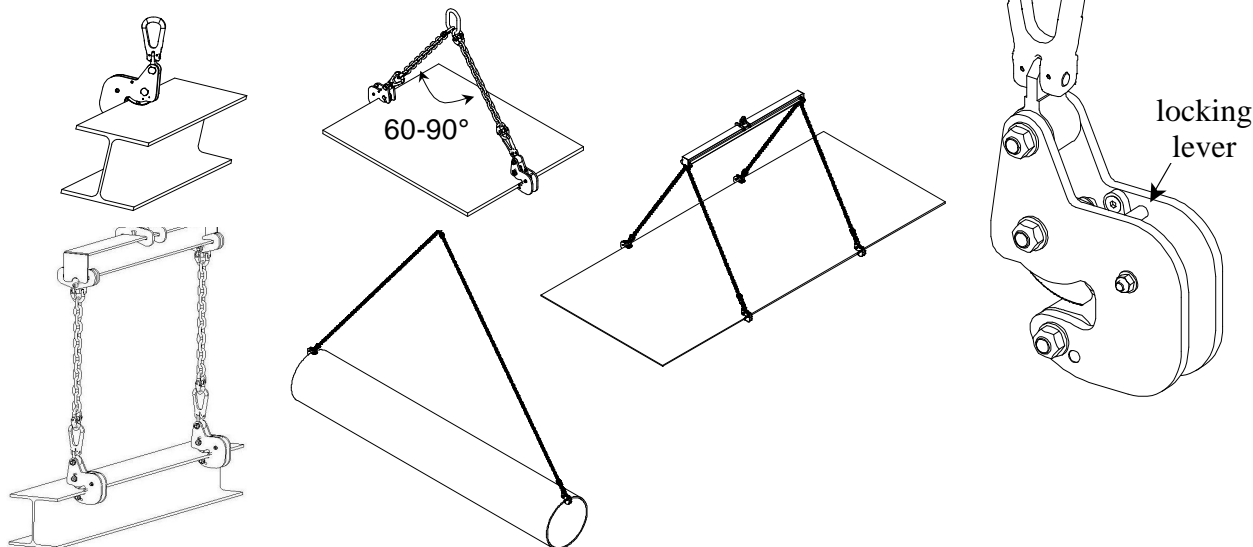

Description

Clamp fitted with a safety spring mechanism allowing permanent contact of the cam on the load to be lifted, even when it is being laid down. This model is also equipped with an automatic grasping ensuring the clamp's closing when the plate or profile is positioned at the back of the clamp's throat. The locking lever does not stick out so that it cannot be damaged. The corrugated cam only marks one side of the load.

Functioning

So as to open the clamp's cam, push the lever situated on top between the 2 flanges until the trigger activates ; the clamp thus locks itself in the open position. When the load is driven home into the clamp's throat, the trigger activates and the clamp closes automatically.

The corrugated cam penetrates the load's material. Lifting ensures proportional clamping. To release the clamp, push the lever downwards. The clamp may also be used without the automatism being activated. To do so, use the manual opening and closing thanks to the lever without bringing it to its limit stop (trigger not activated).

Use in pairs (with a lifting beam in case of several pairs) and 2-legged sling(s) for handling horizontal plates.

General characteristics

- Manufactured without load bearing welds.
- Hot epoxy coating.
- Safety factor: 3 in accordance with the EN 13155.2003 norm.
- Product conforms to the French regulation, in particular the decree of 01/03/2004 relating to the check on lifting devices and the European Directive n°98/37.
- Product with EC marking and delivered with a declaration of conformity and instructions for use.

Important instructions

- The plate or piece to be lifted must always be driven home into the throat of the clamp.
- Load maximum surface hardness: 330 HB and minimum tensile strength 20 daN/ mm².
- Some stainless steels are particularly abrasive ; closely check the condition of the cam's teeth in this case.
- For safety's sake, ensure the clamps are always unlocked when not in use (closed cam).
- Never lift more than one plate/ girder at a time.
- Apply the downgradation if necessary.
- Recommended sling angle when lifting horizontal plates: 60 to 90°.
- The minimum weight of lifting load should be equal to 5% of the clamp's WLL (eg if clamps WLL is 1000 kg, then minimum weight is 50 kg). This value is given for a clamp in perfect working order and respecting Tractel Solutions SAS conditions of use and recommendations. Consult Tractel in case of loads with weight inferior to the minimum recommended value.
- Lifting clamps are not suitable for creating permanent joints.
- Working temperature: -20° to +100°C.

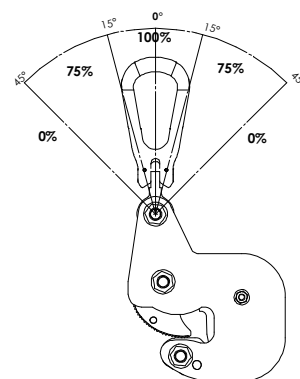

Dimensional characteristics

Ref.	Group code	WLL kg	Opening		A	B	C	D	F	G	H	I	J	Weight kg
			min	max										
KP1 0-20	50218	1 500	0	20	283	144	120	40	71	40,5	13,5	11	62	3,3
KP2 0-30	50228	3 000	0	30	417	214	185	62	115	66	22	20,5	92	9,8

Dimensions in mm

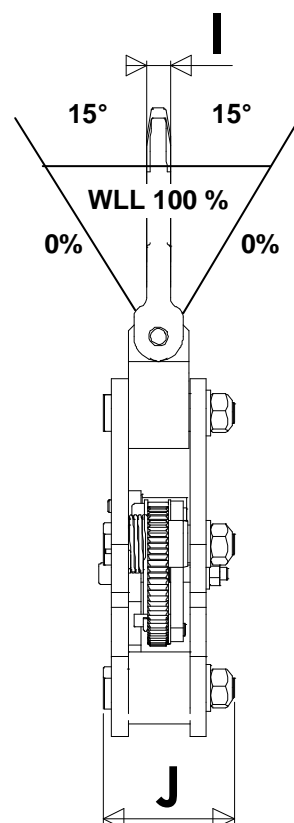
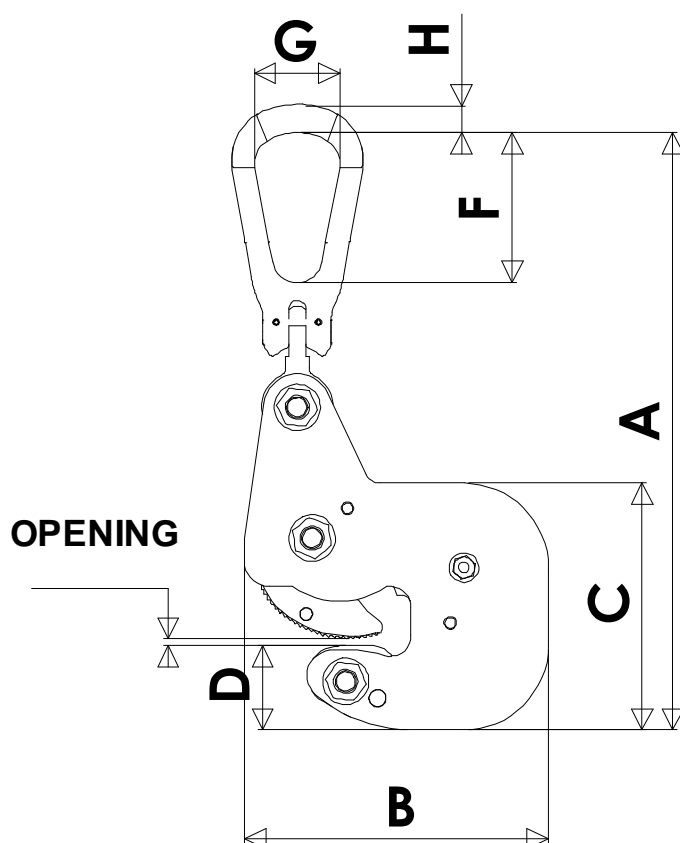

Never exceed the allowed 15° angle between the ring and the flanges

Applications

Provides a fixed or temporary suspension point.
Lifting of I or H profiles.

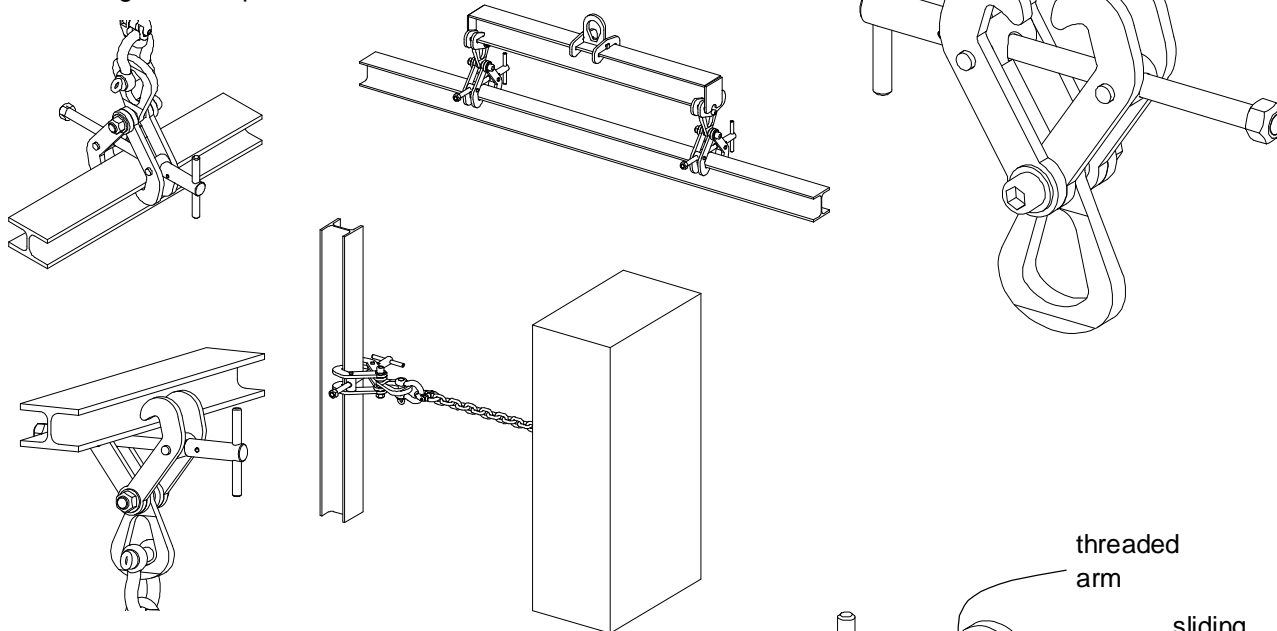

Description

These beam clamps are fitted with a screw allowing the locking in position for providing an hanging point. One of the arms slides, therefore allowing the easy positioning and clamping of the loaded beam clamp. The use is made easier thanks to a handle.

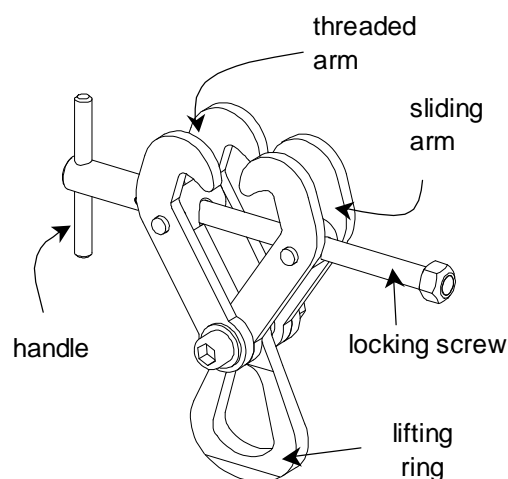

Functioning

The clamp opening is adjusted thanks to the sliding arm and the locking screw. The clamp is immobilized on the profile:

- by activating the locking screw when providing an hanging point
- by sliding the arm in case of lifting operation (closing without any intervention).

The clamp's loading ensures proportional clamping.

Important instructions

- When the profile's width is superior to K dimension (see opposite chart), the operator must locate the beam clamp sliding it from the profile end.
- Use in pairs with a lifting beam when lifting profiles.
- Only lift one profile at a time.
- Always operate the effort in the flanges' direction: do not pull sideways with an angle superior to 15°.
- Working temperature: -20° to +100°C.

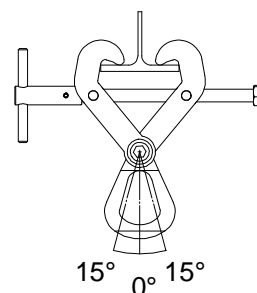

General characteristics

- Manufactured without load bearing welds.
- Hot epoxy coating.
- Safety factor: 3 in accordance with the EN 13155.2003 norm.
- Product conforms to the French regulation, in particular the decree of 01/03/2004 relating to the check on lifting devices and the European Directive n°98/37.
- Product with EC marking and delivered with a declaration of conformity and instructions for use.

Dimensional characteristics

Ref.	Group code	WLL kg	Opening		A	B	C	D	E	F	H		I		J		K max**	L min	Weight kg
			min*	max**							min	max	min	max	min	max			
GP1 60-180	50158	1 000	60	180	52	69	18	16	68	106	181	206	20	30	138	243	165	3	3,6
GP2 60-200	50168	2 000	60	200	64	80	23	20	68	115	208	234	17	29	177	285	185	3	5,6
GP3 60-300	50178	3 000	60	300	64	80	23	20	76	130	230	274	19	42	237	404	235	3	8,4
GP5 100-390	50188	5 000	100	390	74	92	36	25	76	130	274	332	15	48	260	493	360	3	10,8
GP10 100-390	50198	10 000	100	390	98	120	45	25	108	164	312	365	13	47	288	513	350	3	20,5

* min value is for case 1 (clamping on profile flange)

no min value for case 2 (clamping on profile web)

** IMPORTANT : When the profile's width is superior to K dimension, the operator must locate the beam clamp sliding it from the profile end.

Dimensions in mm

CASE 1: clamping
on girder flange

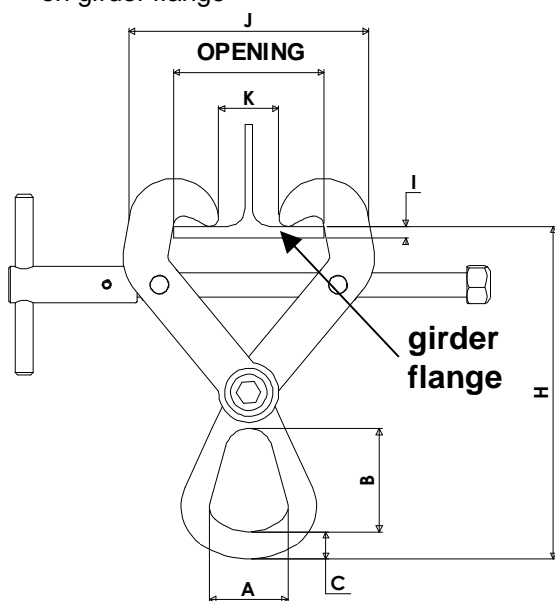

CASE 2: clamping
on girder web

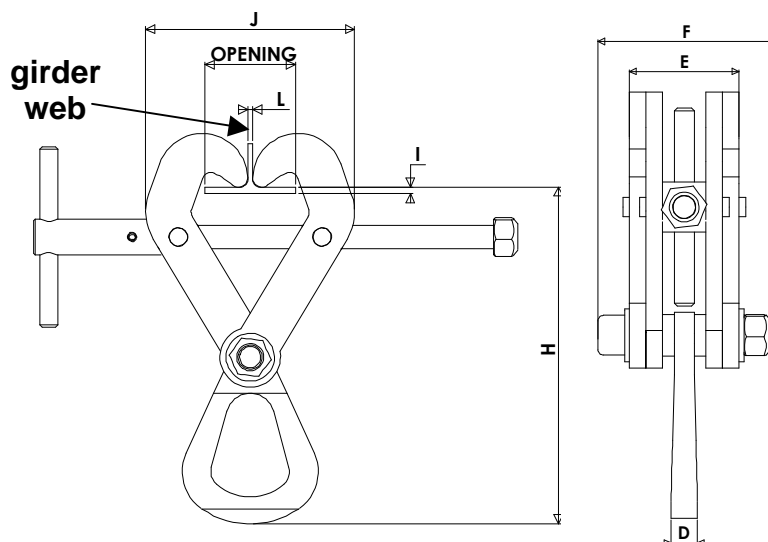

Applications

Lifting of I or H-profiled girders.

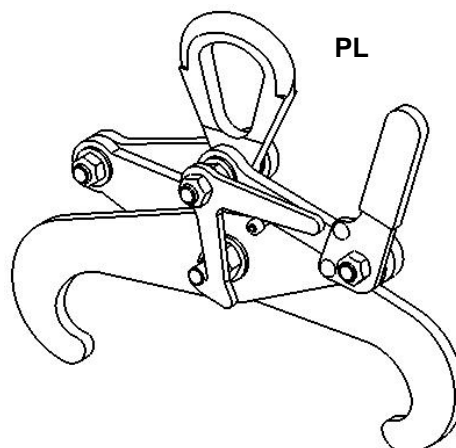
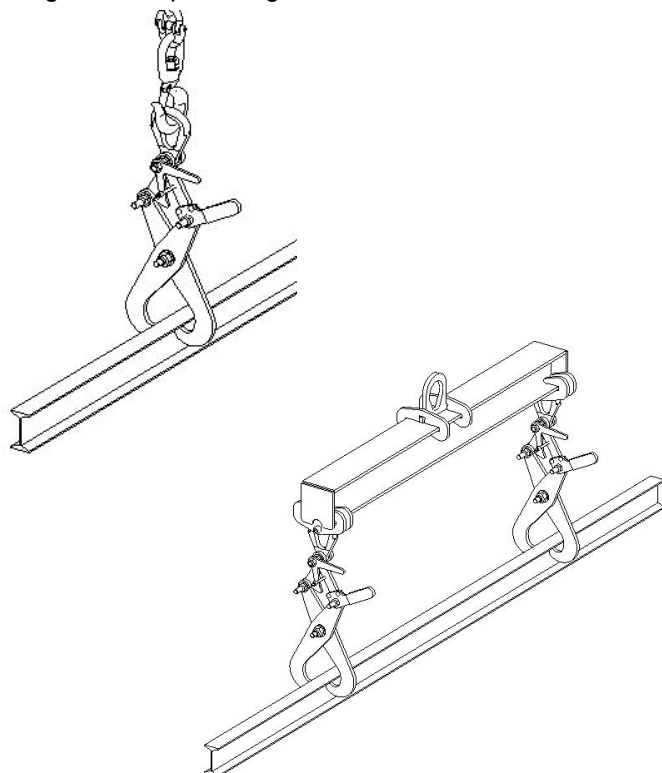

PL

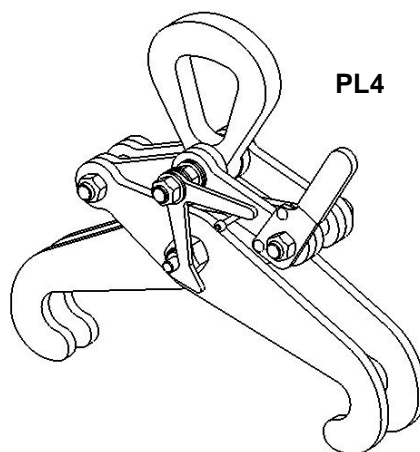

PL4

Description

These accessories are fitted with an open position locking system allowing to lay down the load without any intervention on the clamp.

Functioning

Place the clamp locked open over the profile. Lift up the lever while starting off the lift and hold it in the up position to prevent from locking again against the fastening screw. Lifting ensures proportional clamping, thus minimising load marking. When laying down, the clamp automatically locks itself open. Handles make the positioning easier.

Important instructions

- Only lift one profile at a time.
- Vertical traction only.
- Use in pairs with a lifting beam recommended.
- PL3: for any profile whose width exceeds 420 mm, the operator must locate the clamp sliding it from the profile end.
- It is possible to use this range of clamps on girders with a flange width less than the indicated one ; in this case, use in pairs with a lifting beam (clamping on profile's stem).
- Do not use inverted ie ring downwards (as fixing point): use GP beam clamps.
- Working temperature: -20° to +100°C.

General characteristics

- Manufactured without load bearing welds.
- Hot epoxy coating.
- Safety factor: 3 in accordance with the EN 13155.2003 norm.
- Product conforms to the French regulation, in particular the decree of 01/03/2004 relating to the check on lifting devices and the European Directive n°98/37.
- Product with EC marking and delivered with a declaration of conformity and instructions for use.

Dimensional characteristics

Ref.	Group code	WLL kg	Opening			A		B		C		D	E	F	G	H	I	J max	K max for		L min	Weight kg
			min for		max	min	max	min	max	min	max								min open.	max open.		
			case 1	case 2																		
PL1 95-200	50568	1 000	95	46	200	182	348	284	405	284	504	18	52	69	16	98	42	230	46	48	3	4
PL2 120-300	50578	2 000	120	55	300	196	462	275	405	348	604	23	64	80	20	119	50	330	30	20	3	7,5
PL3 180-450	50588	3 000	180	64	450*	296	627	326	482	435	768	36	74	92	25	143	61	420*	23	56	3	15
PL4 120-300	50598	4 000	120	55	300	196	444	275	404	398	622	36	74	92	25	154	73	310	30	20	3	15

* PL3 model: for any profile whose flange width (dimension "opening" on drawings) exceeds 420 mm the operator must locate the clamp sliding it from the profile end.

Dimensions in mm

CASE 1: clamping on girder flange

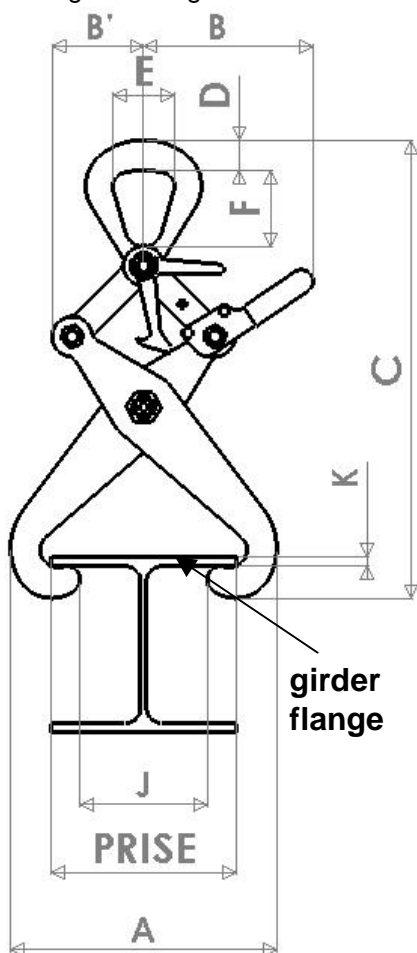

CASE 2: clamping on girder web

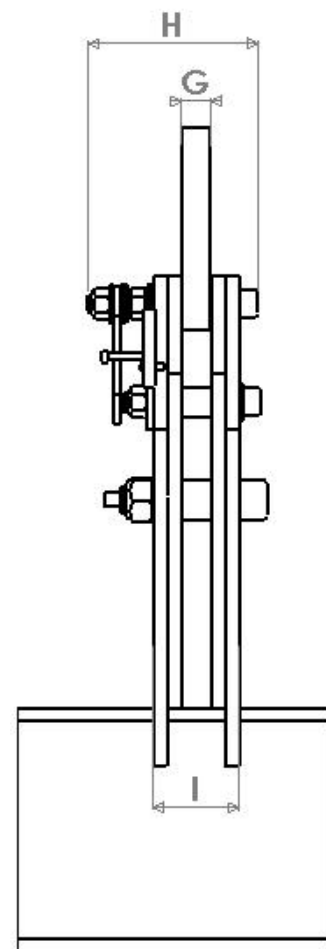
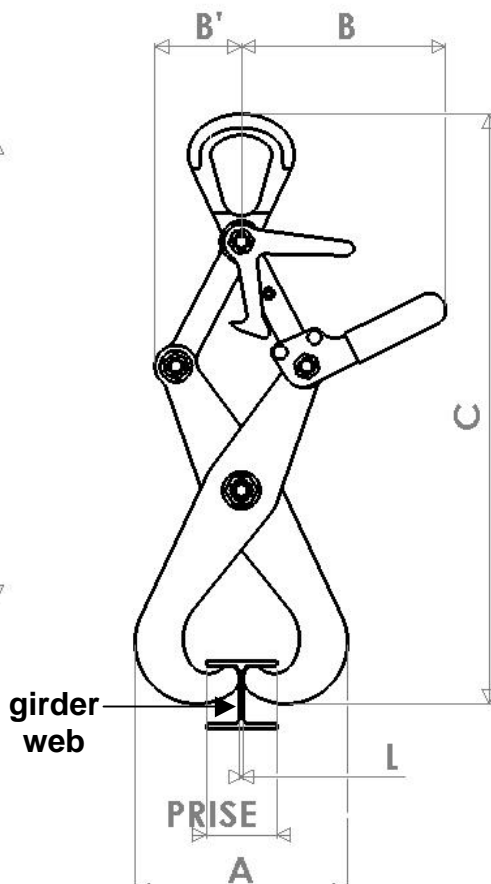

Applications

Lifting of round or square bars, tubes, and various small profiles individually or in hooped bundles.

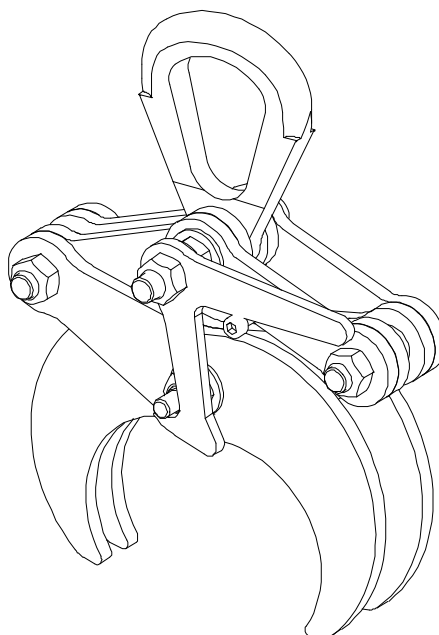
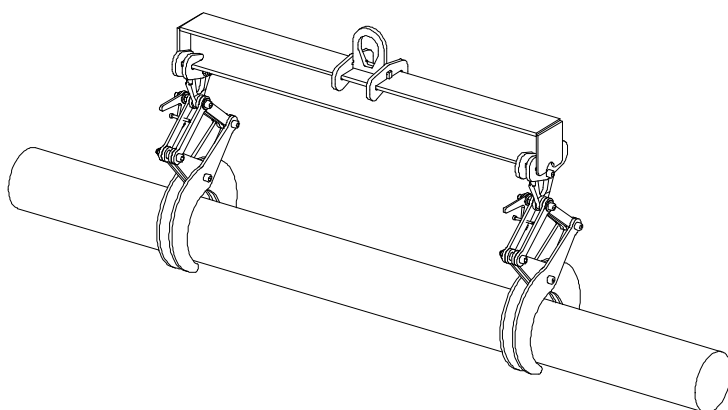
**Description**

These accessories are fitted with an open position locking system allowing to lay down the load without any intervention on the clamp.

Functioning

Place the clamp locked open over the load. Lift up the lever and hold it in the up position while starting off the lift to prevent it from locking again against the fastening screw. When laying down, the clamp automatically locks itself open.

Important instructions

- Use in pairs with a lifting beam recommended.
- Vertical traction only.
- When lifting bundles, ensure each piece is correctly secured by the clamps.
- Working temperature: -20° to +100°C.

General characteristics

- Manufactured without load bearing welds.
- Hot epoxy coating.
- Safety factor: 3 in accordance with the EN 13155.2003 norm.
- Product conforms to the French regulation, in particular the decree of 01/03/2004 relating to the check on lifting devices and the European Directive n°98/37.
- Product with EC marking and delivered with a declaration of conformity and instructions for use.

Dimensional characteristics

Ref.	Group code	WLL kg	Opening		A		B		C		D	E	F	G	H	I	Weight kg
			min	max	min	max	min	max	min	max							
RT05 50-100	50748	500	50	100	314	359	136	170	146	187	100	16	44	69	52	18	4
RT1 100-200	50758	1 000	100	200	475	563	241	318	222	296	100	16	44	69	52	18	9
RT2 200-350	50768	2 000	200	350	745	872	427	544	355	447	100	20	60	80	64	23	27
RT3 250-450	50778	3 000	250	450	839	1010	485	634	546	650	100	20	68	80	64	23	40

Dimensions in mm

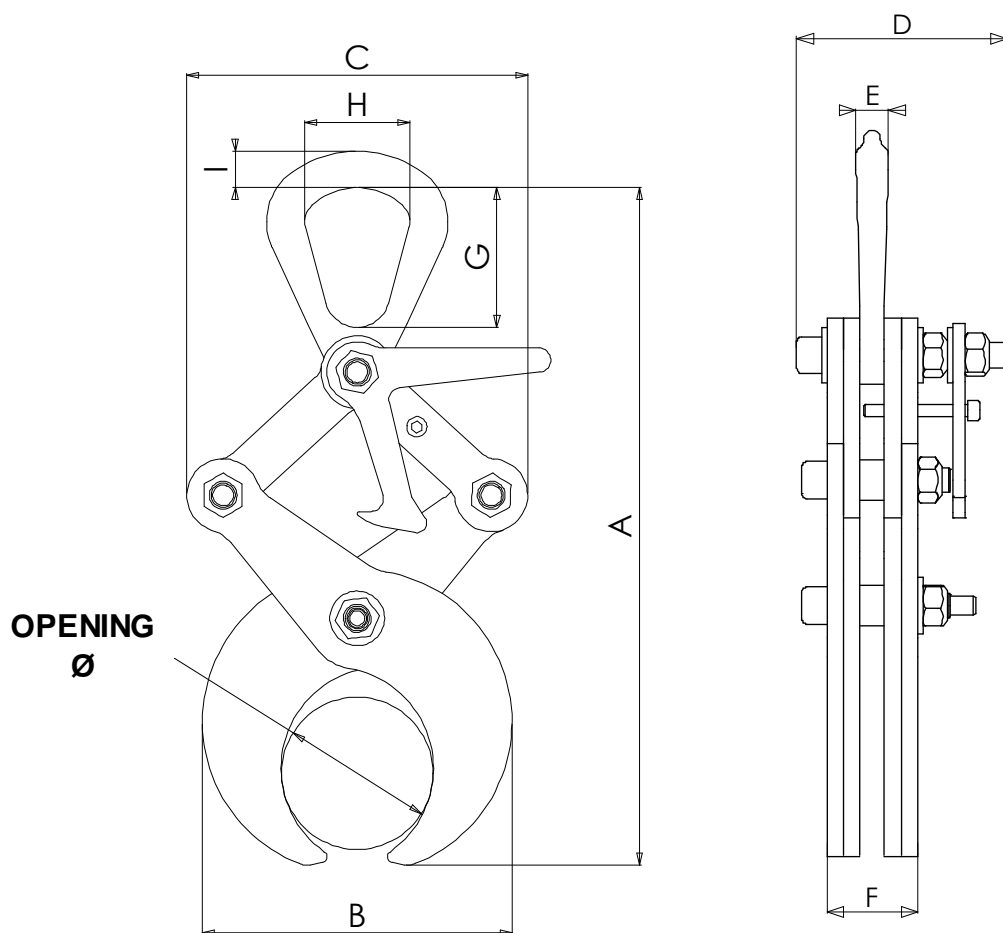

Applications

Lifting and turning without marring of loads with parallel sides made of various materials such as wood, concrete, steel, plastic, rock...

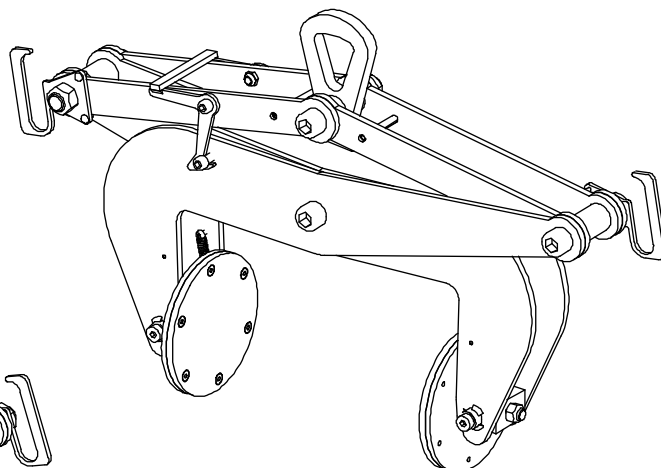
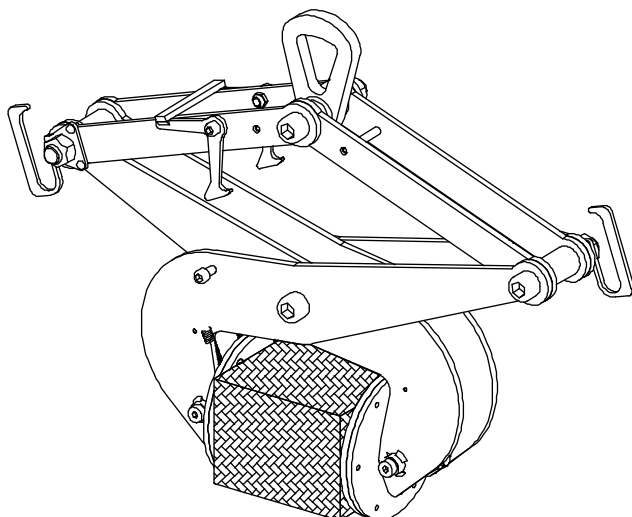

Description

These accessories are fitted with an open position locking system allowing to lay down the load without any manual intervention. Polyurethane coated pads ensure a great adherence and avoid load marring ; articulated and pivoting, they also enable load turning. Transport handles make the positioning easier. Clamping is proportional to the load, thus minimising the damage risk.

Functioning

Place the clamp locked open over the load. Lift up the lever, while starting off the lift and hold it in the up position to prevent it from locking again against the fastening screw. When laying down, the clamp automatically locks itself open.

Important instructions

- Make sure the pads are free from grease or oil.
- Degrease the pads regularly.
- Do not lift greasy or oily pieces or with smooth surface (eg. polished marble).
- Only lift one load at a time.
- Do not lift blocks with a size exceeding the opening capacity of the clamp used.
- The minimum weight of lifting load should be equal to 5% of the clamp's WLL (eg if clamps WLL is 1000 kg, then minimum weight is 50 kg). This value is given for a clamp in perfect working order and respecting Tractel Solutions SAS conditions of use and recommendations. Consult Tractel in case of loads with weight inferior to the minimum recommended value.
- Lifting clamps are not suitable for creating permanent joints.
- Working temperature: -20° to +90°C.

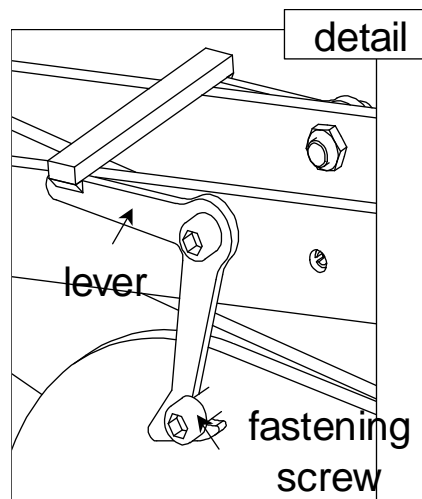

General characteristics

- Manufactured without load bearing welds.
- Hot epoxy coating.
- Safety factor: 3 in accordance with the EN 13155.2003 norm.
- Product conforms to the French regulation, in particular the decree of 01/03/2004 relating to the check on lifting devices and the European Directive n°98/37.
- Product with EC marking and delivered with a declaration of conformity and instructions for use.

Dimensional characteristics

Ref.	Group code	WLL kg	A		B		C		D	E	Opening		G	H	I	J	K	Weight kg	L
			min	max	min	max	min	max			min	max							
ZAC 60-250	51288	1 500	427	526	505	922	815	955	32	112	60	250	200	29	65	82	20	46	110
ZAC 250-390	51298	1 500	640	696	590	880	940	976	32	112	250	390	200	29	65	82	20	54	190
ZAC 390-650	51308	1 500	840	973	630	1175	990	1150	32	112	390	650	200	29	65	82	20	62	180
ZAC 600-1000	51318	1 500	1115	1350	640	1550	1155	1450	32	112	600	1000	200	29	65	82	20	84	175
ZAC 700-1250	51328	1 500	1400	1735	785	2135	1660	2090	32	112	700	1250	200	29	65	82	20	129	265

Dimensions in mm

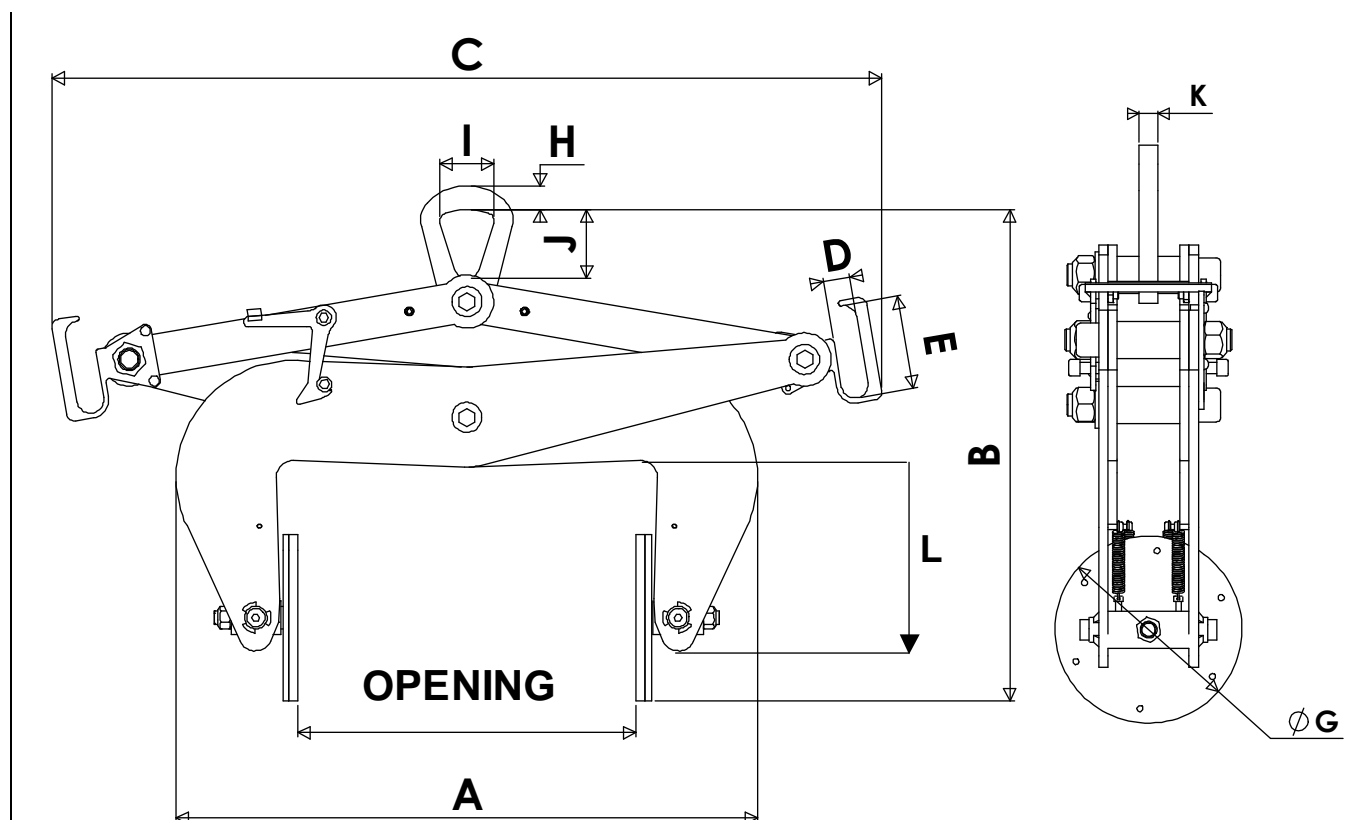

Applications

Lifting without marking of products with parallel sides made of various materials such as wood, concrete, steel, plastic, rock...

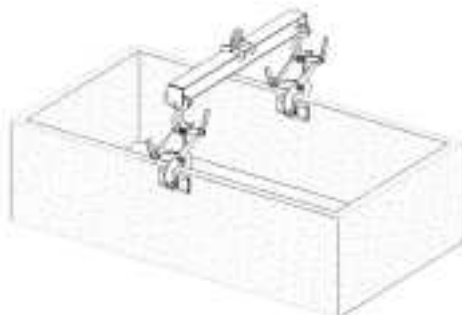

PB05

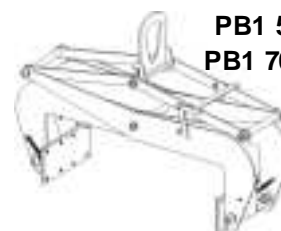

**PB1 500-800
PB1 700 -1000**

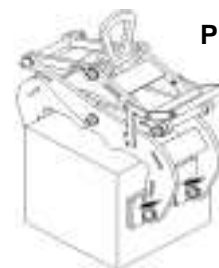

PB3

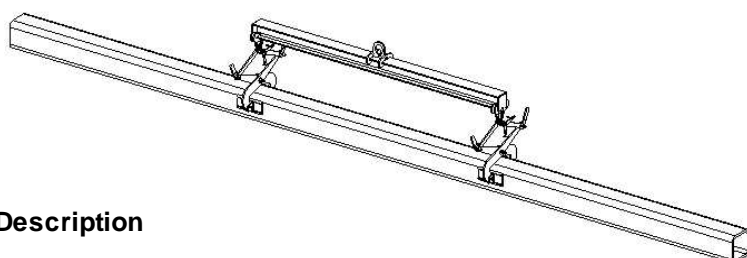

Description

These accessories are fitted with an automatic lower lock allowing to lay down the load without any manual intervention. Rubber coated pads ensure a great adherence and avoid load marking. Transport handles make the positioning easier. Clamping is proportional to the load, thus limiting the damage risk.

Functioning

Place the clamp locked open over the load. Lift up the lever while starting off the lift and hold it in the up position to prevent it from locking again against the fastening screw. When laying down, the damp automatically locks itself open.

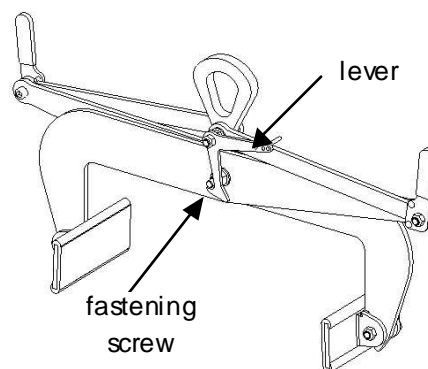

Important instructions

- Make sure the pads are free from grease or oil.
- Do not lift greasy or oily pieces or with smooth surface (eg. polished marble).
- Only lift one load at a time.
- Do not lift blocks with a size exceeding the opening capacity of the clamp used.
- The minimum weight of lifting load should be equal to 5% of the damp's WLL (eg if damp's WLL is 1000 kg, then minimum weight is 50 kg). This value is given for a damp in perfect working order and respecting Tractel Solutions SAS conditions of use and recommendations. Consult Tractel in case of loads with weight inferior to the minimum recommended value.
- Lifting clamps are not suitable for creating permanent joints.
- Working temperature: -20° to +90°C.

General characteristics

- Manufactured without load bearing welds.
- Hot epoxy coating.
- Safety factor: 3 in accordance with the EN 13155.2003 nom.
- Product conforms to the French regulation, in particular the decree of 01/03/2004 relating to the check on lifting devices and the European Directive n°98/37.
- Product with EC marking and delivered with a declaration of conformity and instructions for use.

Dimensional characteristics

Ref.	Group code	WLL kg	Opening		A		B		C		D	E	F	G	H	I	J	K		Weight kg
			min	max	min	max	min	max	min	max								min	max	
PB05 0-100	50458	500	0	100	320	551	545	600	236	290	69	18	52	16	96	200	95	118	150	10
PB05 100-250	50468	500	100	250	340	684	575	680	345	440	69	18	52	16	96	200	95	113	127	12
PB05 200-500	50478	500	200	500	464	1031	823	975	578	734	80	23	64	20	96	200	95	203	261	20
PB1 0-200	50488	1 000	0	200	459	837	750	847	392	484	80	23	64	20	130	200	125	190	240	25
PB1 200-500	50498	1 000	200	500	550	1160	870	1085	635	812	80	23	64	20	130	200	123	175	240	47
PB1 500-800	50508	1 000	500	800	781	1370	1045	1200	1003	1146	170	38	110	10	150	300	289	287	337	71
PB1 700-1000	50518	1 000	700	1000	915	1481	1162	1304	1205	1330	170	38	110	10	150	300	286	364	407	78
PB3 200-500*	88368	3 000	200	500	888	1237	797	894	743	879	170	38	110	20	150	389	334	302	364	131
PB3 500-800*	88378	3 000	500	800	1025	1462	1018	1109	1057	1181	170	38	110	20	150	389	334	318	377	181

* PB with standard polyurethane coating

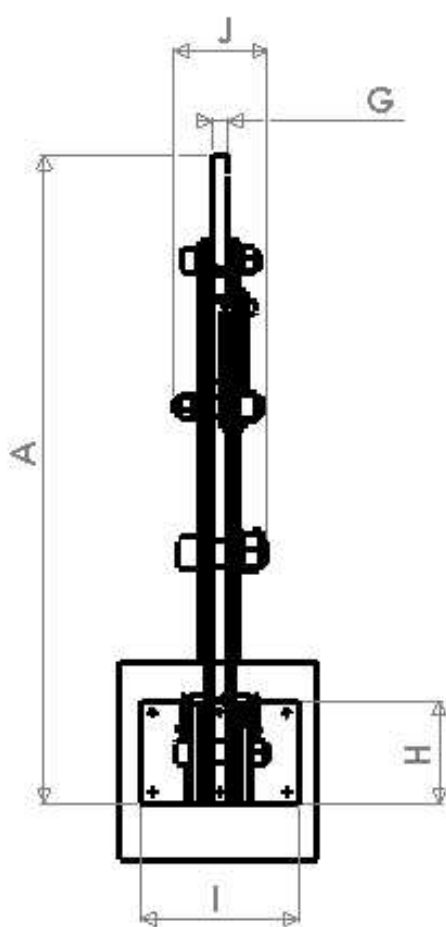
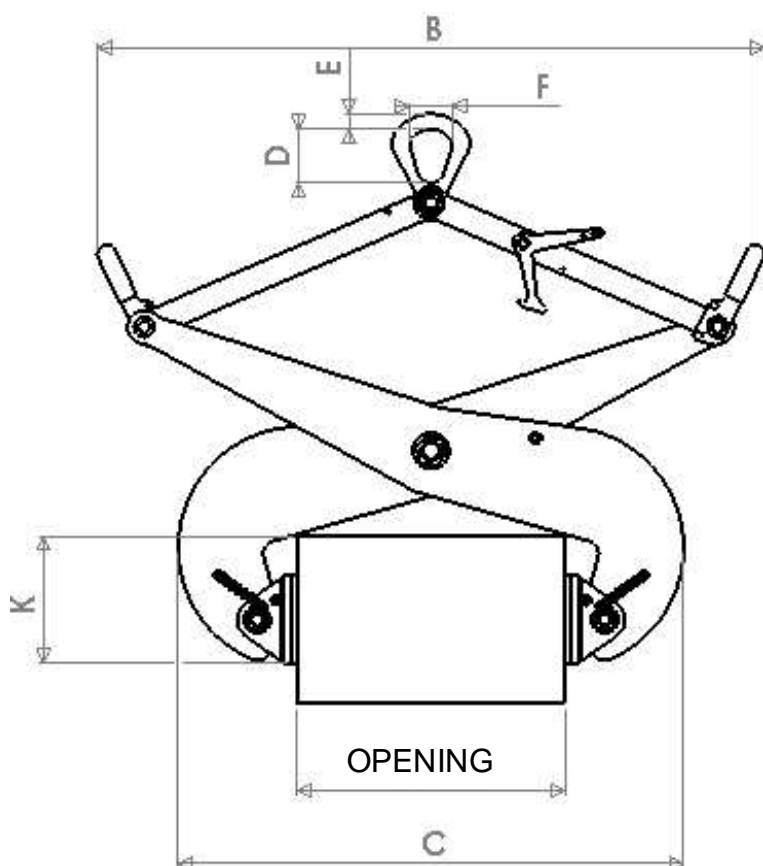

Options on request

- Pads coated with polyurethane.
- Pads with steel points (for slack loads).
- Centred or V-shaped pads

Applications

Lifting without marring of products with parallel sides made of various materials such as wood, concrete, steel, plastic, rock ...

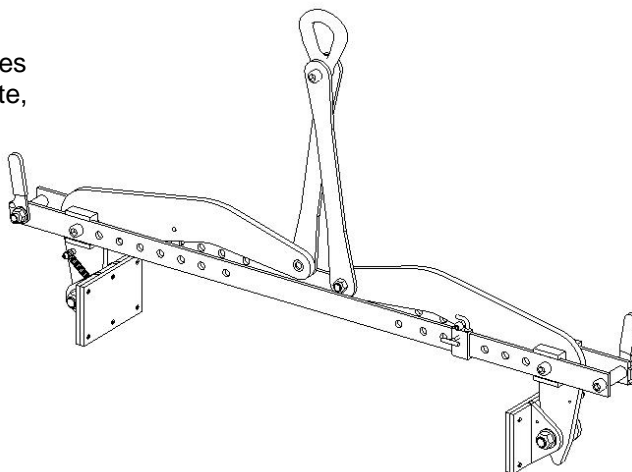
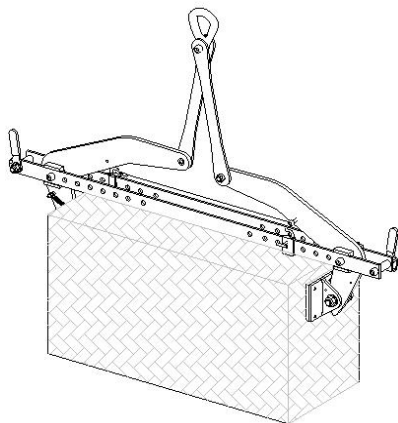

Description

These accessories are fitted with an open position locking system allowing the positioning on the load. Rubber coated pads ensure a great adherence and avoid load marring. Clamping is proportional to the load, thus minimising the damage risk.

Functioning

Adjust the clamp's opening, sliding the jaws' adjusting broach on either side (symmetrical adjustment from 200 to 1000 mm to a 100 mm-increment). Place the clamp locked open over the load. Unlock the catch hooks and perform lifting. Once the load has been laid down, slide back the catch hooks on their own pin so as to lock the clamp open.

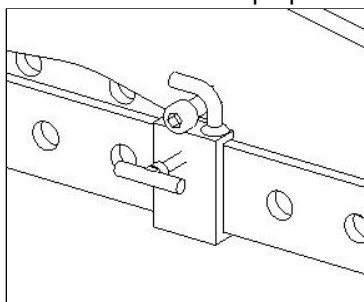

catch hooks detail

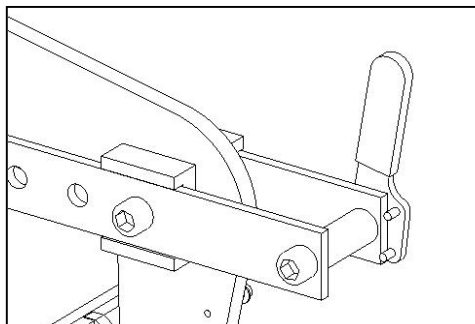

adjusting broach detail

Important instructions

- The pads must be free from grease or oil.
- Degrease the pads regularly.
- Do not lift greasy or oily pieces or with smooth surfaces (eg. polished marble).
- Only lift one load at a time.
- Do not lift blocks with a size exceeding the opening capacity of the clamp used.
- Both broaching positions of the clamp's arms should be symmetrical with relation to the lifting point.
- For each grasping dimension, observe the broaching positions to guarantee the gripping power necessary for lifting (see instructions for use).
- The minimum weight of lifting load should be equal to 5% of the clamp's WLL (eg if clamps WLL is 1000 kg, then minimum weight is 50 kg). This value is given for a clamp in perfect working order and respecting Tractel Solutions SAS conditions of use and recommendations. Consult Tractel in case of loads with weight inferior to the minimum recommended value.
- Lifting clamps are not suitable for creating permanent joints.
- Working temperature: -20°C to +90°C.

General characteristics

- Manufactured without load bearing welds.
- Hot epoxy coating.
- Safety factor: 3 in accordance with the EN 13155.2003 norm.
- Product conforms to the French regulation, in particular the decree of 01/03/2004 relating to the check on lifting devices and the European Directive n°98/37.
- Product with EC marking and delivered with a declaration of conformity and instructions for use.

Dimensional characteristics

Ref.	Group code	WLL kg	Opening		A		B		C	D		F	G	H	I	J	K	L	Weight kg
			min	max	min	max	min	max		min	max								
PP1-200-1000	50608	1000	200	1000	666	722	187	195	1470	560	1280	20	166	130	200	80	64	23	42

Dimensions en mm

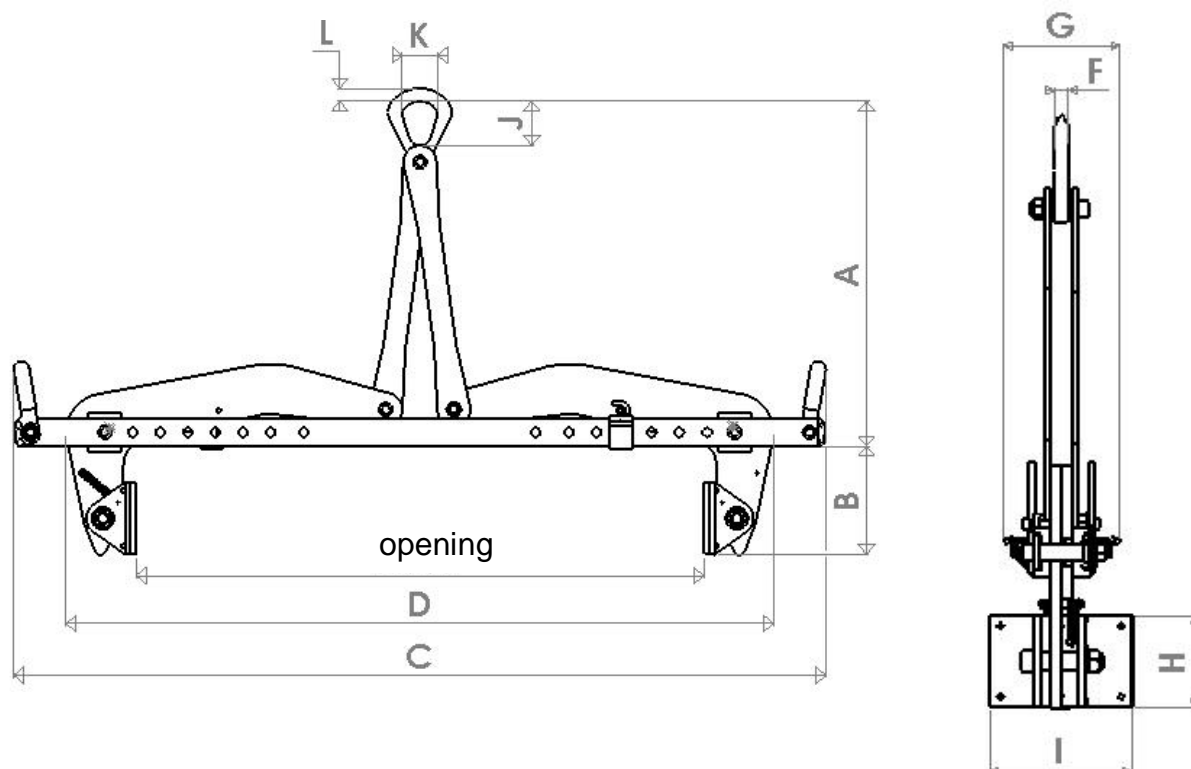

Options on request

- Pads coated with polyurethane.
- Pads with steel points (for slack loads).